



Sule Koc

/

portfolio

www.sulekoc.com



SULE KOÇ

+90 (532) 424-6800

info@sulekoc.com

www.sulekoc.com



www.facebook.com/SuleKocDesign/



www.instagram.com/sulekocdesign/



www.twitter.com/sulekoc



www.linkedin.com/company/sule-koc-design

PROFILE

As an industrial designer focusing on product and spatial design projects, i have designed products for a variety of sectors including furniture, transportation, lighting and construction elements industry. After 7 years of experience as a design director in multidisciplinary design offices, i launched my own studio in 2010. My works have been recognised by international awards including Red Dot Design Awards and German Design Awards and have had collaborated with leading companies on design and consultancy.

Running my own studio has made me develop a wholistic perspective that includes different aspects of projects such as management, strategy and communication. In design processes, I am in search for user behaviours, interactions and semantics of products in order to create brand new relations and solutions. For the next part of my journey, i am looking forward to be a part of a team to create more impactful projects, continuously learn and create value.

AWARDS



reddot design award
winner 2009



INTERNATIONAL DESIGN
EXCELLENCE AWARDS '14
FINALIST



GERMAN DESIGN
AWARD
SPECIAL
2016



BIGSEE
PRODUCT DESIGN
AWARD 2020
WINNER

JURY MEMBERSHIPS

2020 ISTANBUL SENIN, Jury Member
2019 Design Turkey Awards, Jury Member
2016 IMMIB Design Awards, Plastic Category, Jury Member
2016 Yurtbay Ceramics Design Awards, Jury Member
2015 IMMIB Design Awards, Lighting Category, Jury Member

LECTURES

OZYEGIN UNIVERSITY / ID STUDIO 2018-present, Part time Lecturer
BILGI UNIVERSITY / ID STUDIO 2016, Part time Lecturer
BEYKENT UNIVERSITY / ID STUDIO 2015, Part time Lecturer

EXHIBITIONS & WORKSHOPS

Facilitator and Invited Participant Designer

2020 IM DESIGN, INEGOL, TR workshop
2018 YOLGECEN, IST workshop
2019 ATLAS HARRAN, STOCKHOLM exhibition
2019 DESIGN MONAT GRAZ, GRAZ exhibition
2019 SALON AKARETLER, IST exhibition
2015 BAKSI MUSEUM, 10th ANNIVERSARY PROJECT, IST exhibition
2014 POLSKA IN BETWEEN, Istanbul Design Bienalle, PL-TR exhibition
2013 TALENT A LA CARTE, MAISON OBJECT, PARIS exhibition
2012 TASTE OF IST, IST exhibition
2012 STATES OF MATTER, ARMAGGAN GALLERY, IST exhibition
2012 DESIGN SPIRIT, IST exhibition
2011 IST MEETS WEST, CH
2011 DESIGN FOR ISTANBUL CYMBALS, IST exhibition
2011 DESIGN SPIRIT, IST exhibition
2010 SPAGAT!, GERMANY exhibition and book

WORKS

2010

• SULE KOC DESIGN

OWNER / DESIGN DIRECTOR / LECTURER

The studio provides design services in both product and spatial design areas. Having been cooperated with the leading companies like Bombardier, Kale and Eczacıbaşı, the studio aims to maintain a wholistic approach to design from concept to production on a wide range of projects from product to space. Services;

- Product Design
- Spatial Design
- Design Consultancy
- UX Design

LECTURER

OZYEGIN UNIVERSITY / ID STUDIO 2018 - present Part time Lecturer
BILGI UNIVERSITY / ID STUDIO 2016 Part time Lecturer
BEYKENT UNIVERSITY / ID STUDIO 2015 Part time Lecturer

2006

• DEMIRDEN DESIGN

DESIGN DIRECTOR

- Project management : Coordinating teams of manufacturers and junior designers communication with suppliers, cost analysis, monitoring the prototypes, ensuring all components meet the quality standards and making sure that the design concept is translated into the manufacturing in a correct way.
- Design: Designing product & spatial design projects according to the briefs, direct communication with clients in order to get clear briefs and product strategies.

2004

• BIRIM MOBILYA

PRODUCT DESIGNER

- Generating furniture design concepts.
- Prototype monitoring.
- Computer generated product visualisation.

EDUCATION

2004

- MIDDLE EAST TECHNICAL UNIVERSITY
B.Sc. INDUSTRIAL DESIGN / Honour Degree

IDF Interaction Design Foundation

Mobile UX Design Certificate
Design Thinking Certificate
Psychology of Interaction Design Certificate

SOFTWARE

RHINOCEROS



AUTODESK 3D MAX



AUTODESK AUTOCAD



ADOBE XD



ADOBE PHOTOSHOP



ADOBE ILLUSTRATOR



INTERESTS

Japanese Culture
Electronic Music, Live Code Music
Singing, Hafif Korku Music Band
New Media Art, VR and AR
Computer Aided Art



Aura

scent nebuliser

HOW TO DESIGN A RITUAL THROUGH SCENTS

- Designing an oil nebulising scent diffuser for a florist company
- Creating a sustainable bond with the brand through rituals
- Differentiation by creating an innovative and better quality diffuser compared to the ones in the market

Black Diamond

armchair



reddot design award
winner 2009



CLIENT

iljo

Multidisciplinary Product Design Company

www.iljo.eu

GOAL

- As a brand new company that aims to create high quality design objects, different concepts are evaluated from different product categories.
- Designing an upholstered armchair that aims to reflect the brand values and be a pioneer for the furniture category of the brand.

CONCEPT

- Black Diamond provides different seating positions when it is rotated around the outer surfaces. Wide angle position provides a leaning posture, when rotated, another backrest angle appears which allows upright postures.
- The body appears to be extracted out of a larger mass, angled corners and surfaces provide a comfortable seating experience in a complex geometry. When they are positioned side by side at different angles, this geometry makes the arm chairs look dissimilar.



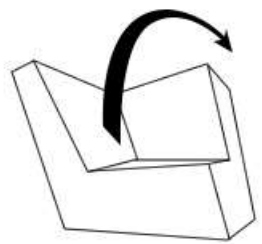

1. →

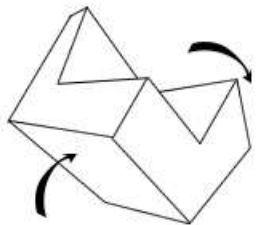

2. →

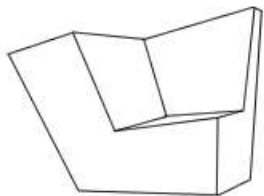

3.



Aura

scent diffusing nebuliser



CLIENT

A florist shop that aims to launch a product line around scents.

GOAL

- Designing a chargeable scent nebuliser for a flower store that aims to make a connection between the flower customers and the brand, owning a pioneer position in the scent industry.
- Differentiation by creating a better quality and innovative diffuser compared to the existing ones in the market.
- Defining a ritual via the product is required.

CONCEPT

- Aura aims to refer to the feeling of a scent. The vague but strong sensation of a scent comes into body with multilayered structure.
- Aura is a chargeable scent nebuliser which consists of two capsules that share the same base. The outer capsule is icy glass which has an opening at the top which lets the scent vapour to the air. The inner capsule contains the main hardware.
- Real dried flowers are placed into the cavity between the layers of the capsules. The user is able to replace them with new ones or they place whatever they like to keep inside. Using real flowers creates a tangible reference to the florist store.





CEREMONY
IN BLOOM



nebuliser bottle

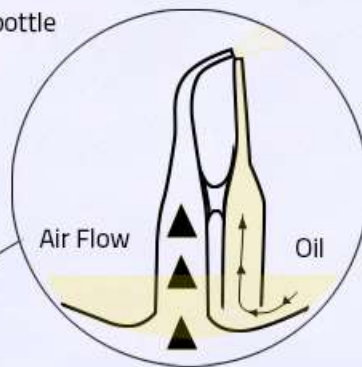

- Frosted glass
- Aluminum case
- Nebuliser bottle
- Essential oil
- ABS inner case
- Buck Converter
- Air pump motor
- Rechargeable battery
- TP4056 battery charger
- Touch sensor switch + USB port

Inserting & Ejecting flowers / objects

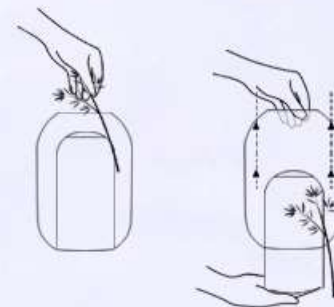

Activation

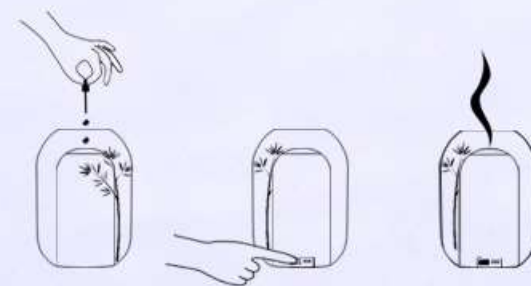

Cleaning



Baz: Biz

kitchen system design



CLIENT

 Eczacıbaşı

İNTEMA

Eczacıbaşı Holding is a Turkish industrial group of 41 companies, has 12,500 employees. İntema Mutfak is one of its brands that focuses on kitchen furniture.

GOAL

- Designing a conceptual kitchen that is based on the key values of the rebranded company. The design concept is considered as a communication tool for the new branding.
- Togetherness, interaction, appreciating local cuisine and craftsmanship are the key values.

CONCEPT

- Baz: Biz is a family of products that aims to redefine the kitchen as a living space. It encourages interaction, collaboration and productivity.
- All the intensive function and interaction are easily perceived by the consistency of plain design language, ensuring the design to be a canvas for the user to create, transform and customise.
- The family consists of shelves, base cabinets, tall cabinets, island table, short cabinets, mobile pantry cabinet and appliance cabinets.







FİKRERİNİZ BİZİM İÇİN ÖNEMLİ;
BİZİMLE PAYLAŞIN, HAYATA GEÇİRELİM!

İNTEMA | BİZ-BİZ

İNTE
YA
REKLETLER



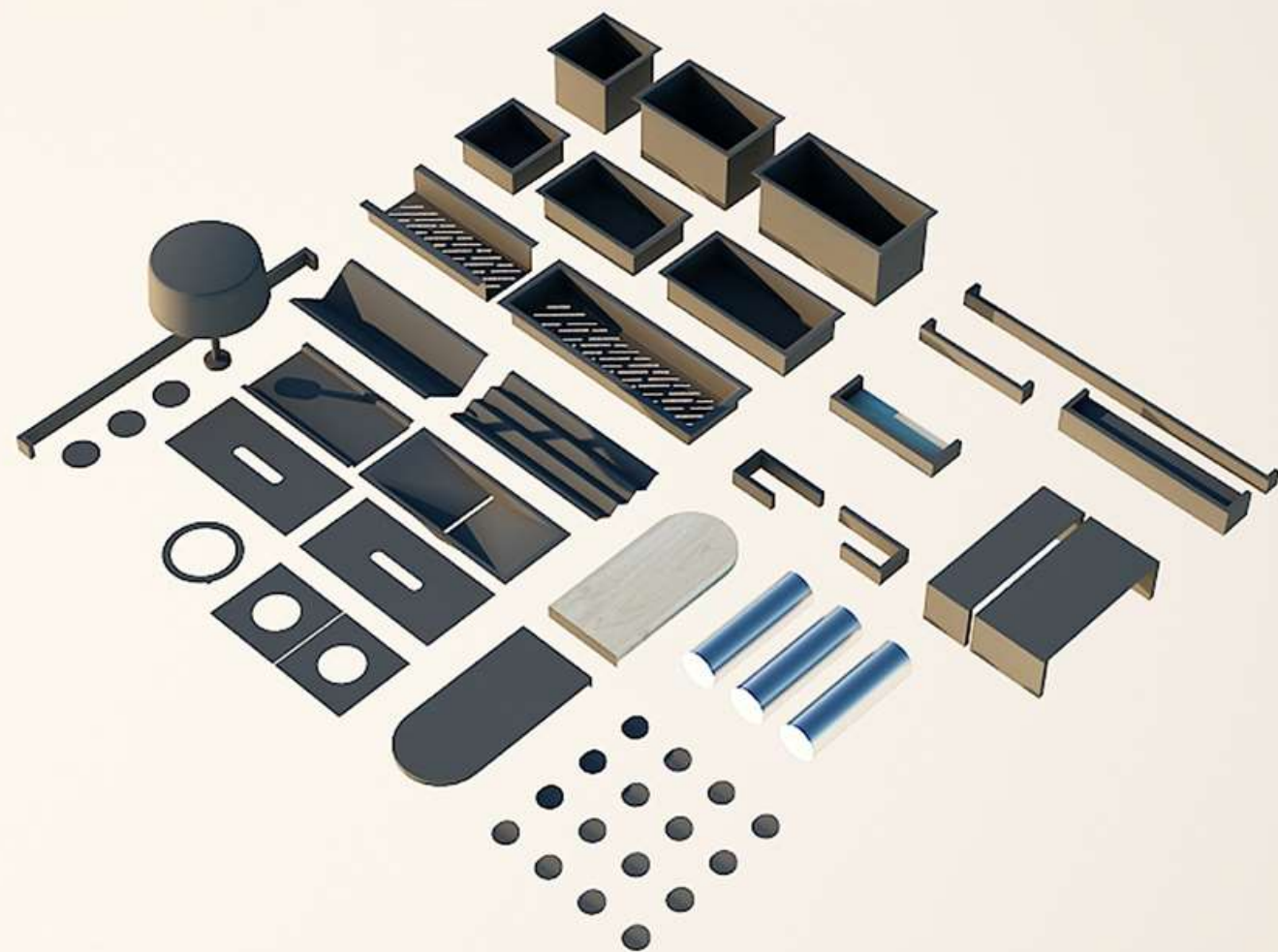

+ Accessories can be located into multiple modules. The mobile pantry unit, the counter and the atelier table are able to host these accessories. The magnetic accessories can be attached to the backboard.



Mobile Pantry Cabinet with customisable containers





FİKİRLERİNİZ BİZİMLE PAYLAŞI

EKOLOJİK SOKAK



Hanger board



Cabinet for kids



Appliance Cabinet



Shelf / Divider







BOMBARDIER

high speed trains
creative consultancy

CLIENT

BOMBARDIER

Leading High Speed Train and Business Aircraft manufacturer.

www.bombardier.com

OBJECTIVES

- Designing High Speed Train Interior Concepts for the bid that is requested by Turkish Government.
- Providing a comprehensive research for Bombardier design engineers to understand Turkish culture
- Cultural consultancy for the communication activities within Turkey.
- Exhibition booth design for Eurasiarail Fair 2016-2017.

*The output of the projects cannot be shown due to NDA agreements, if you have any further questions, please feel free to contact.



HOW

to adopt a globally distributed transportation vehicle to different cultures by

HUMAN-CENTERED DESIGN

- + Involving millions of users with different needs and behaviours, global manufacturers of city transportation require human centered design to adopt their vehicle designs for local culture.
- + Bombardier selected **Şule Koç Design** as its partner in Turkey for the creative consultancy that involves both research and design.

*The output of the projects cannot be shown due to NDA agreements, if you have any further questions, please feel free to contact.

CONTENT

RESEARCH >> DESIGN >> CONSULTANCY

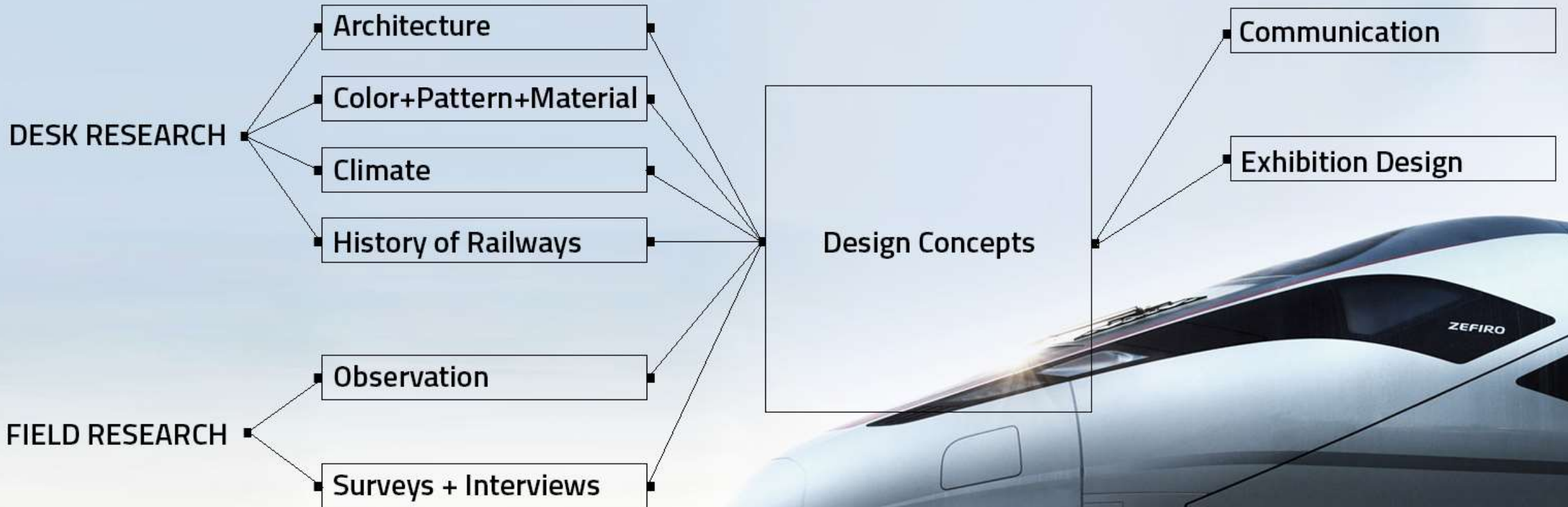

*The output of the projects cannot be shown due to NDA agreements, if you have any further questions, please feel free to contact.

DESK RESEARCH

Architecture

Color+Pattern+Material

Climate

History

The research takes the key examples of indoors, commercial and residential buildings specific to regions.

In terms of **Color+Pattern+Material**, the research looks for the usage of color palettes and how they are perceived. Forbidden colors, meanings of patterns and the materials that are used in craftsmanship are studied.

The **climate** conditions and how it changes the behaviours of people during transportation is also one of the issues in the research.

Historical background is necessary to foresee the relation of people with railways in order to get the perception of familiar features and the possible new ones.



*The output of the projects cannot be shown due to NDA agreements, if you have any further questions, please feel free to contact.

FIELD RESEARCH

Observation Analysis Surveys & Interviews

An analysis report over the current high speed train experience of Turkish railways. Consisting of;

Journey mapping of the current experience in trains.
Observations on how people react to services during the journey.

The behaviours in the indoor environment, how they interact with their surroundings and other passengers.

The materials, patterns and colors that are used in current trains.

A **quantitative survey** amongst 100 passengers and 10 **interviews** had been held. The focus was on their expectations and experiences during their travels by train.

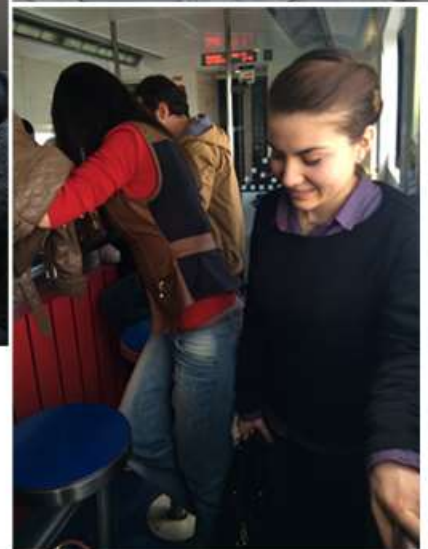

DESIGN & CONSULTANCY

Concept Design of Train Interiors Consultancy for Communication Exhibition Booth Design

5 different **design concepts** had been designed to be proposed for the bid of High Speed Trains. The concept designs cannot be shown due to NDA agreements.

These design themes covered the **color, pattern and material** of all interior elements which would compose a meaningful design language that aims to address the needs and preferences of the users.

Besides the design project, the collaboration continued as a **consultancy for the communication** activities of Bombardier within Turkey. Maintaining a correct dialogue considering cultural codes was the key objective.

The consultancy had been followed by design and installation of the exhibition booth of Bombardier at EurasiaRail 2016 .



Eurasiarail 2016



rail.bombardier.com

*The output of the projects cannot be shown due to NDA agreements, if you have any further questions, please feel free to contact.



**ci contemporary
istanbul**
Art Fair Spatial Design

CLIENT

GOAL

CONCEPT

**ci contemporary
istanbul**

www.contemporaryistanbul.com

- Designing the public spaces of the biggest contemporary fair in Turkey "Contemporary Istanbul".
- These spaces include ticket counters which has to be temporary without any intervention to the congress centre building, lounge areas and hallways.

- The temporary counters are designed to be installed in 1 day by using rented containers.
- Counters are framed with colored semi-transparent vinyls that diffuses the light and connects the counters with each other, that also creates a large entrance without interfering with the building.



ci contemporary
Istanbul

PRESS

TICKET

VIP

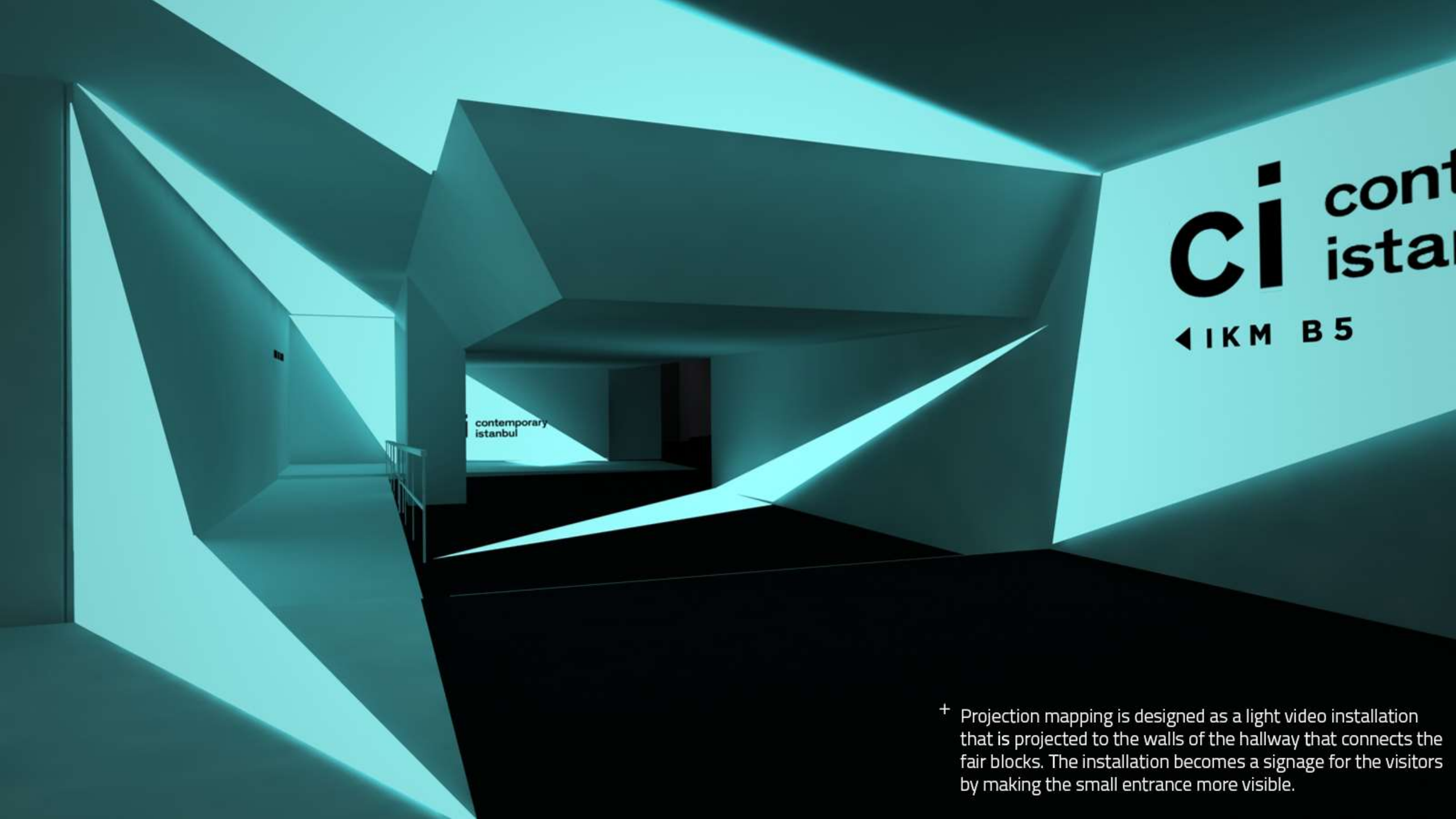

ci cont
ista
◀ 1KM B5

contemporary
istanbul

+ Projection mapping is designed as a light video installation that is projected to the walls of the hallway that connects the fair blocks. The installation becomes a signage for the visitors by making the small entrance more visible.

ci cont
ista

◀ 1KM B5

contemporary
istanbul

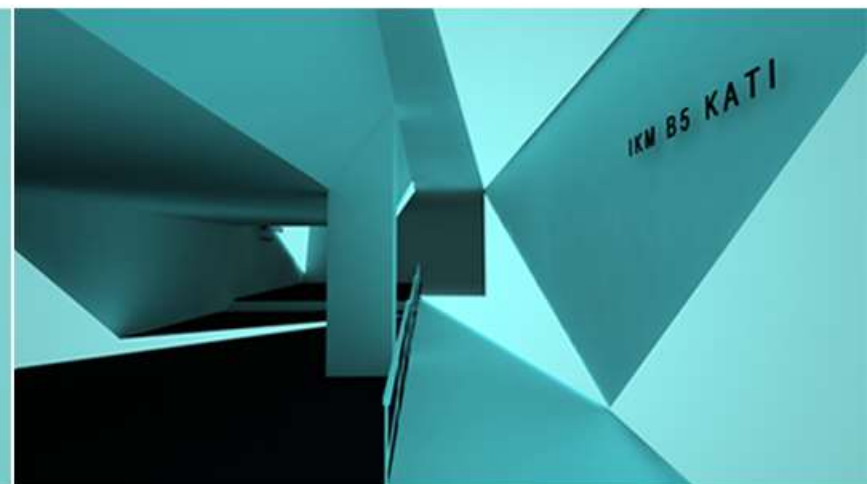
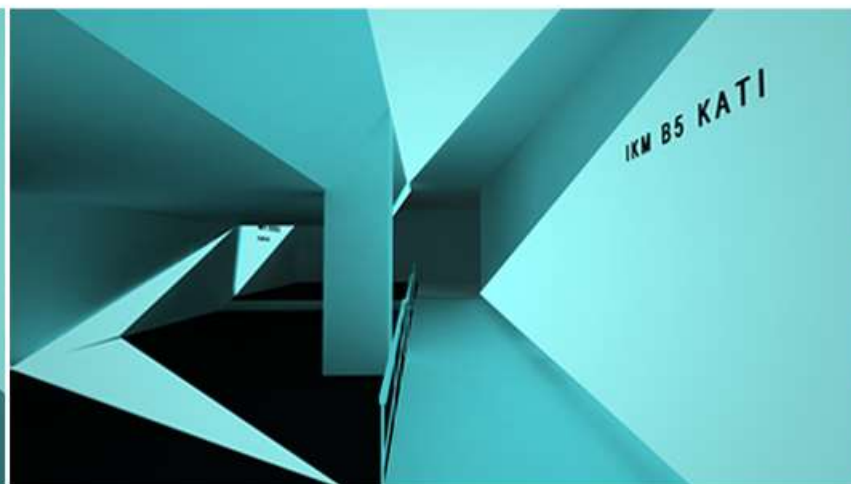
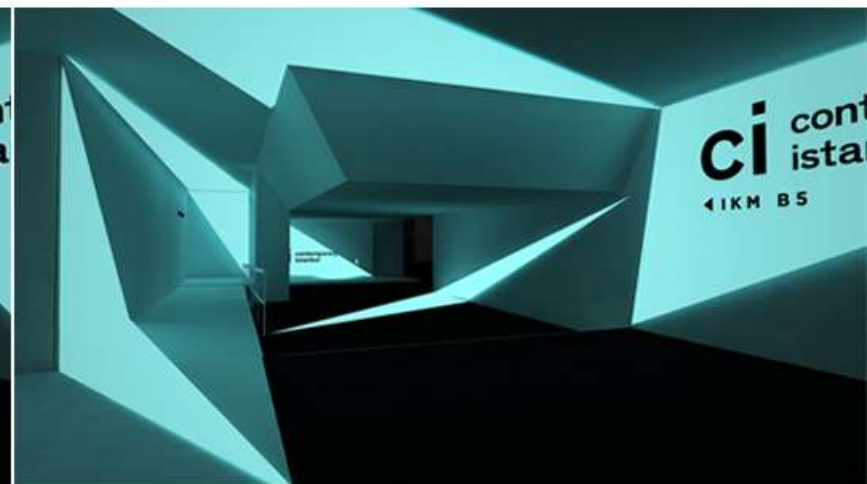
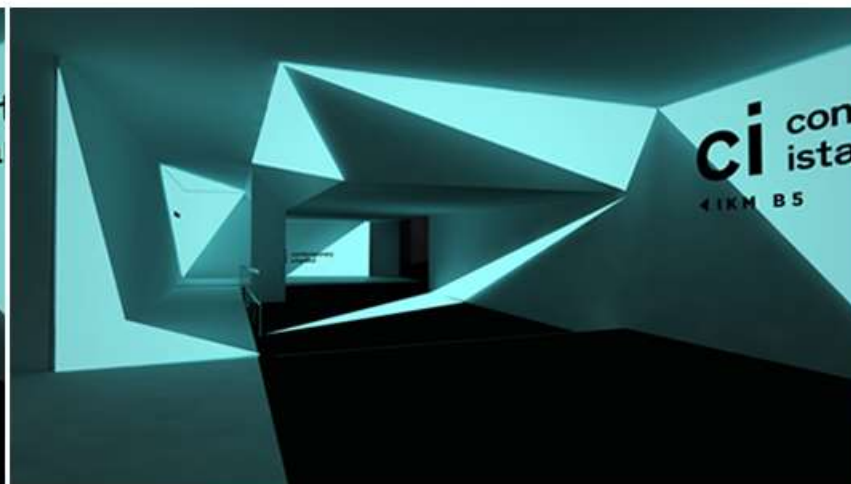
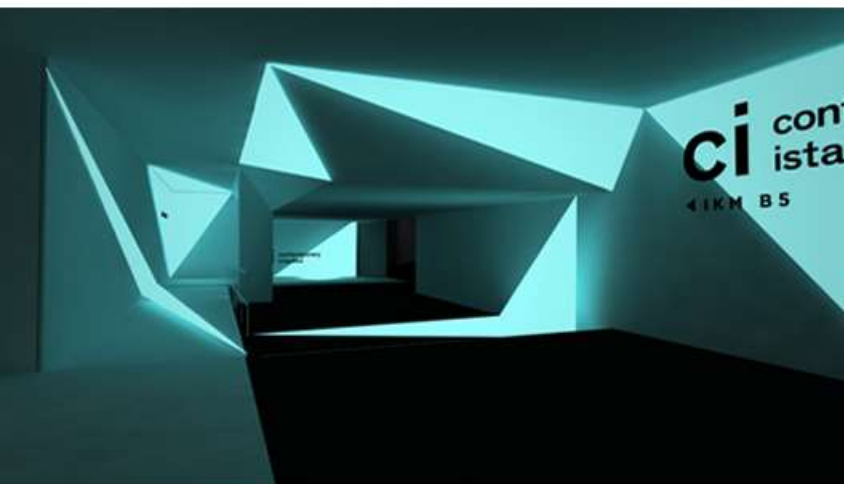

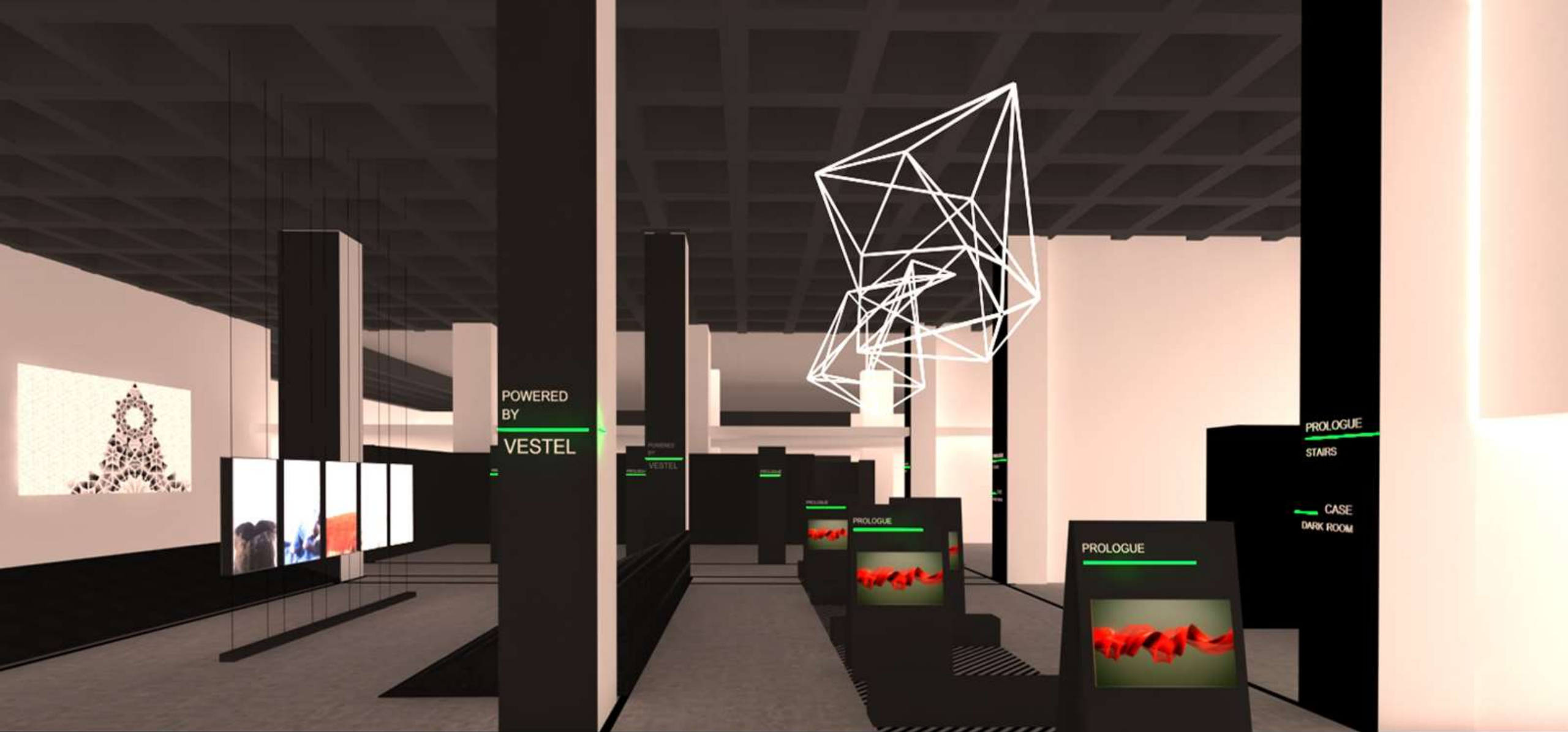

PLUG-IN

Hall for new media arts within Contemporary Istanbul Fair

PLUG IN

THE MILL
PROLOGUE
DWELL
CASE
MILK
UNITED VISUAL-
ARTISTS

POWERED
BY
VESTEL

PROLOGUE
STAIRS

CASE
DARK ROOM



BIG BANG

ICON Magazine Installation

CREDITS

Role: Industrial Designer

Executed together with demirendesign team as a full-time employee. All intellectual property rights are owned by demirdendesign. No claims are made on sole ownership of this material.

www.demirden.com

INFO

- Project: Icon Magazine Installation
- Year: 2008
- Location: Istanbul
- Scope: Event Design, Graphic Design

CONCEPT

- Every design, "the moment of discovery", is like the explosion of a new idea. It grows, develops and spreads through sharing and eventually turns into an icon.



IT'S OK

interior conceptual design

CLIENT

IT'S OK

Catering company and cafe enterprise.

GOAL

- Interior Concept Design of a 2 floor, 900 m² enterprise that focuses on industrial kitchen space rental, food entrepreneurship and catering.

CONCEPT

- Designing a hub space for food startups who are looking for a fully equipped industrial kitchen. The hub consists of 7 kitchens which are designed to accommodate basic needs for industrial food manufacturing, which are also able to be modified according to changing needs. Equipment modulations and room plans are designed simultaneously in order to get maximum efficiency.
- These rooms are designed in a way that employees of startups can keep up the energy and interaction with their colleagues.
- The facility has a catering manufacturing zone for IT'S OK . An experiment area where new products will be developed and workshops will be held.

Floor 0

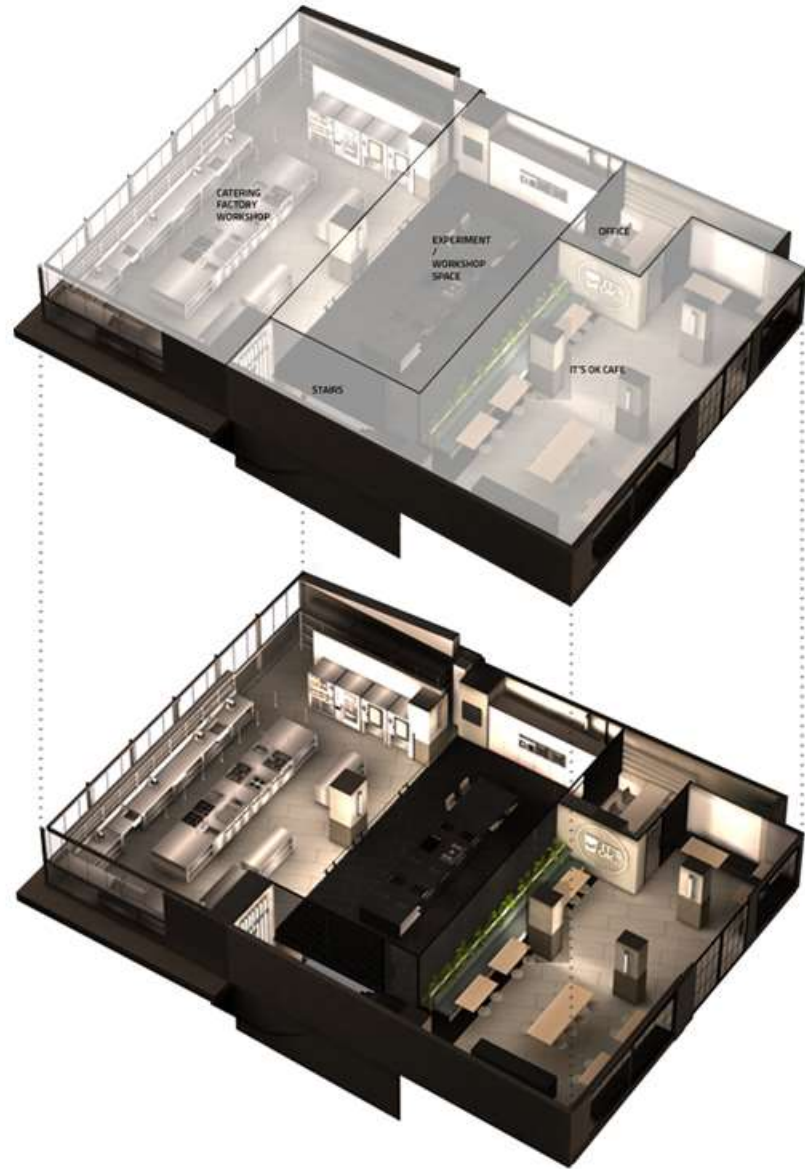

Floor -1



**CATER'S
HUB**

CATER'S
HUB
TEXAS
WC





CATER'S
HUB >>

TERAS >>

WC >>

CATER'S
HUB

CATER'S
HUB >>
TERAS >>
WC >>

CATER'S
HUB >>

TERAS >>

WC >>

<< TERAS

PERSONEL

<< WC

CATER'S
HUB >>

PERSONEL

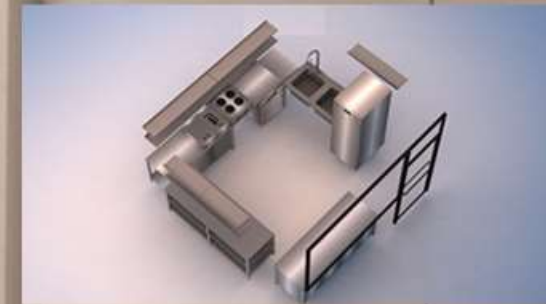

DoL

dice design



CLIENT

Self initiated project

CONCEPT

- "Dots of Lots" is a dice design that is a cubical extraction out of an imaginary space of spheres. In this space, the sections of spheres appear as circles on the sides where come out as three dimensional spheres on the edges. The dice numbers are read through counting the number of these sections. The design brings an innovative perspective to the traditional dice numbering system.



5



4



1



4



4



3



5



2



3



6



3



1



Lava

smart switch

CLIENT



KNX Building Solutions Company

www.eaetechnology.com

GOAL

- For the first B2C product collection of smart switches, EAE Technology requests high design quality concepts which aim to carry them to a competing level in European market.
- Minimalist solutions with an innovative perspective and the adaptability to expand into new functions are the key features.

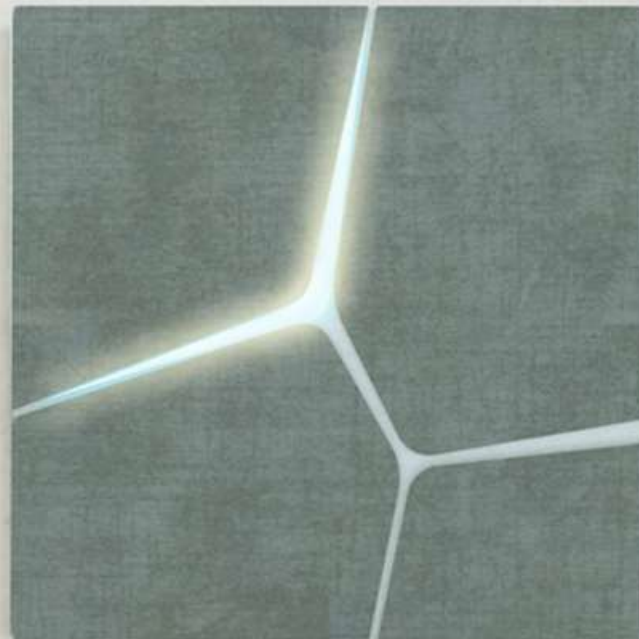

CONCEPT

- Lava offers a variety of combinations on a touch sensitive panel. Users are able to assign different lighting fixtures to different sections. These sections are designed in such a way that will help to organise the rooms according to the space they have. The lighting of the bigger room might be assigned to the bigger section on the switch.
- A light beam appears on the periphery of the activated switch, whereas, when multiple sections are activated, the light beam turns on where these sections intersect.

Lava

- Light beams are diffused through icy acrylic material that are placed between the polished metal plates.
- Polished metal surfaces are equipped with touch sensitive technology and have a coating that prevent fingerprints.



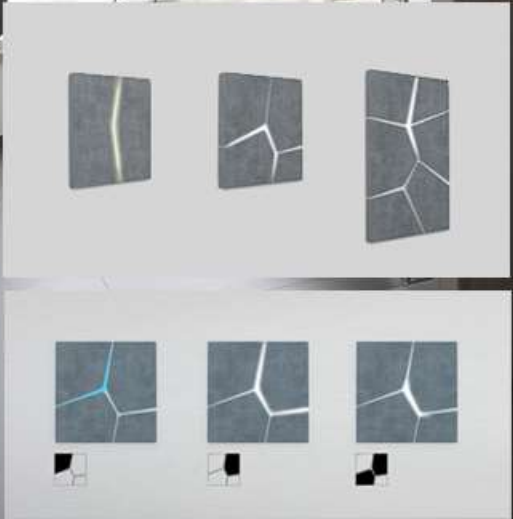

Fortyfive

smart switch

CLIENT



KNX Building Solutions Company

www.eaetechnology.com

GOAL

- For the first B2C product collection of smart switches, EAE Technology requests high design quality concepts which aim to carry them to a competing level in European market.
- Minimalist solutions with an innovative perspective and the adaptability to expand into new functions are the key features.
-

CONCEPT

- The minimal design concept provides a clear, easy to use interface for the touch sensitive surfaces.
- The lightbeam of the activated section is diffused through the frosted acrylic surface. This wide surface makes it easy to recognise the switch in dark.
- The sections are separated by diagonal lines which continues as a frame and expands for wider switches of the series.



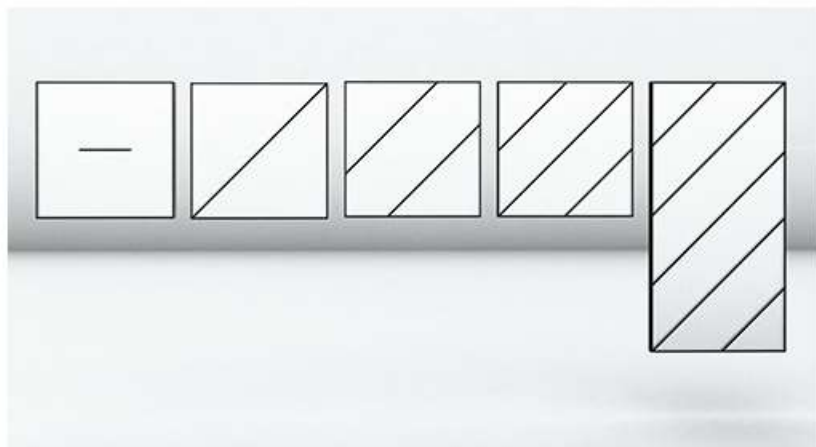



Eclipse

natural stone mosaic wall lining



CLIENT

■ Kale

Leading ceramics and building materials company

www.kale.com.tr

GOAL

- Creating a new wall-lining collection that aims to reintroduce natural stone to young generation of architects.
- Targeting a potential niche in the market by adding design value to a relatively unexplored area.

CONCEPT

- Eclipse is part of a series of a natural stone mosaic collection.
- In search of finding a new design language to transform traditional processing into a modern context, Eclipse reveals new forms and combinations by using the existing production methods.
- It brings out a soft feeling to the hard and rigid material.
- The overlapping of the modules in different heights provides a movement of light-shadow and brings out an infinite cycle without the seam lines.



Eclipse

*natural stone wall-lining
combined with Sinterflex
ceramic tiles*









LAVA INSTALLATION

Lava installation presents an imaginary dinner over the tableware design by Demir Obuz. The installation took place in the gallery launch of the brand "ilio". The shadows of the people who are in interaction with the tableware is projected.

Gravity

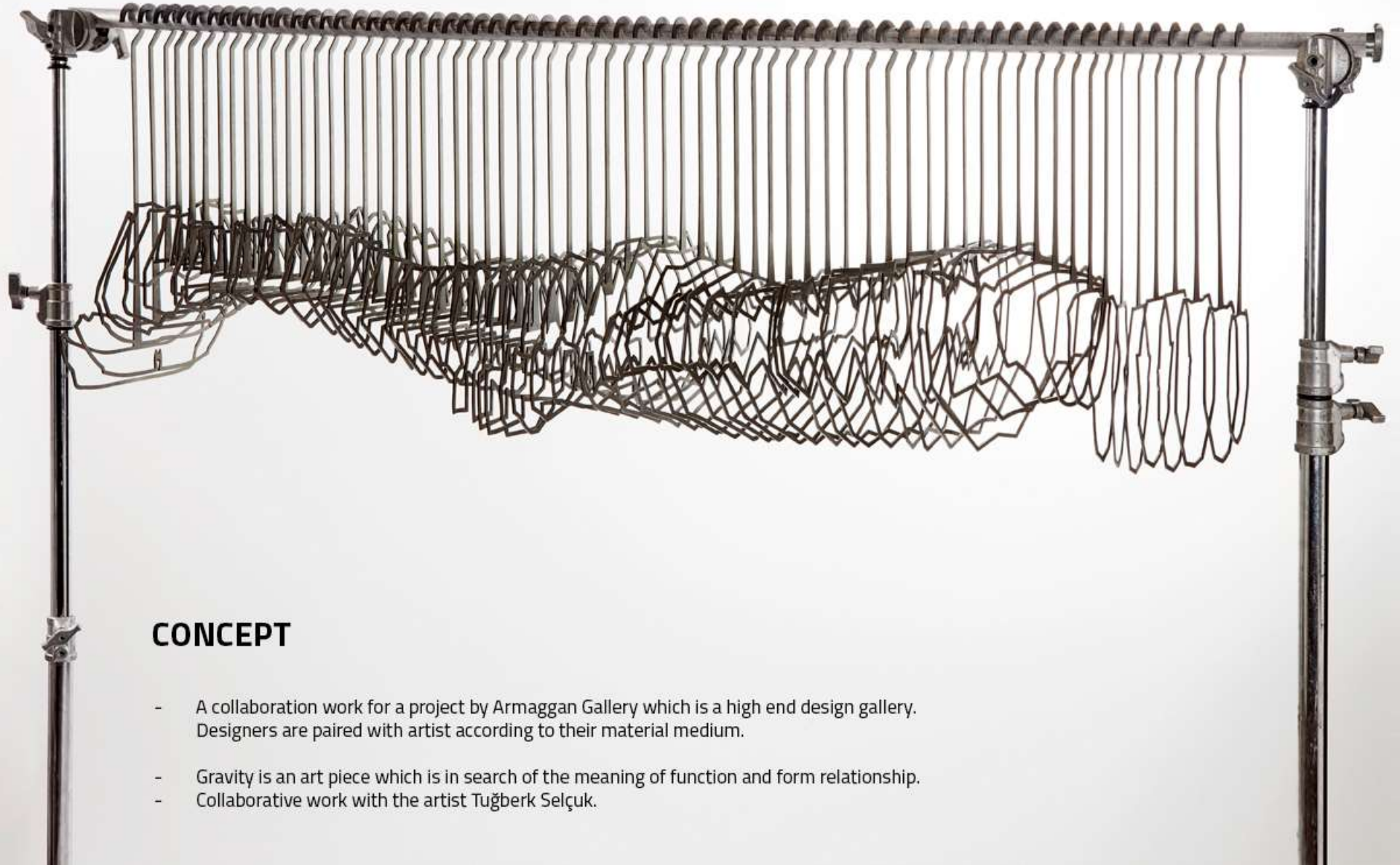

CLIENT



ARMAGGAN
ART & DESIGN GALLERY

www.armaggan.com

CONCEPT

- A collaboration work for a project by Armaggan Gallery which is a high end design gallery. Designers are paired with artist according to their material medium.
- Gravity is an art piece which is in search of the meaning of function and form relationship.
- Collaborative work with the artist Tuğberk Selçuk.

MESH

outdoor furniture design

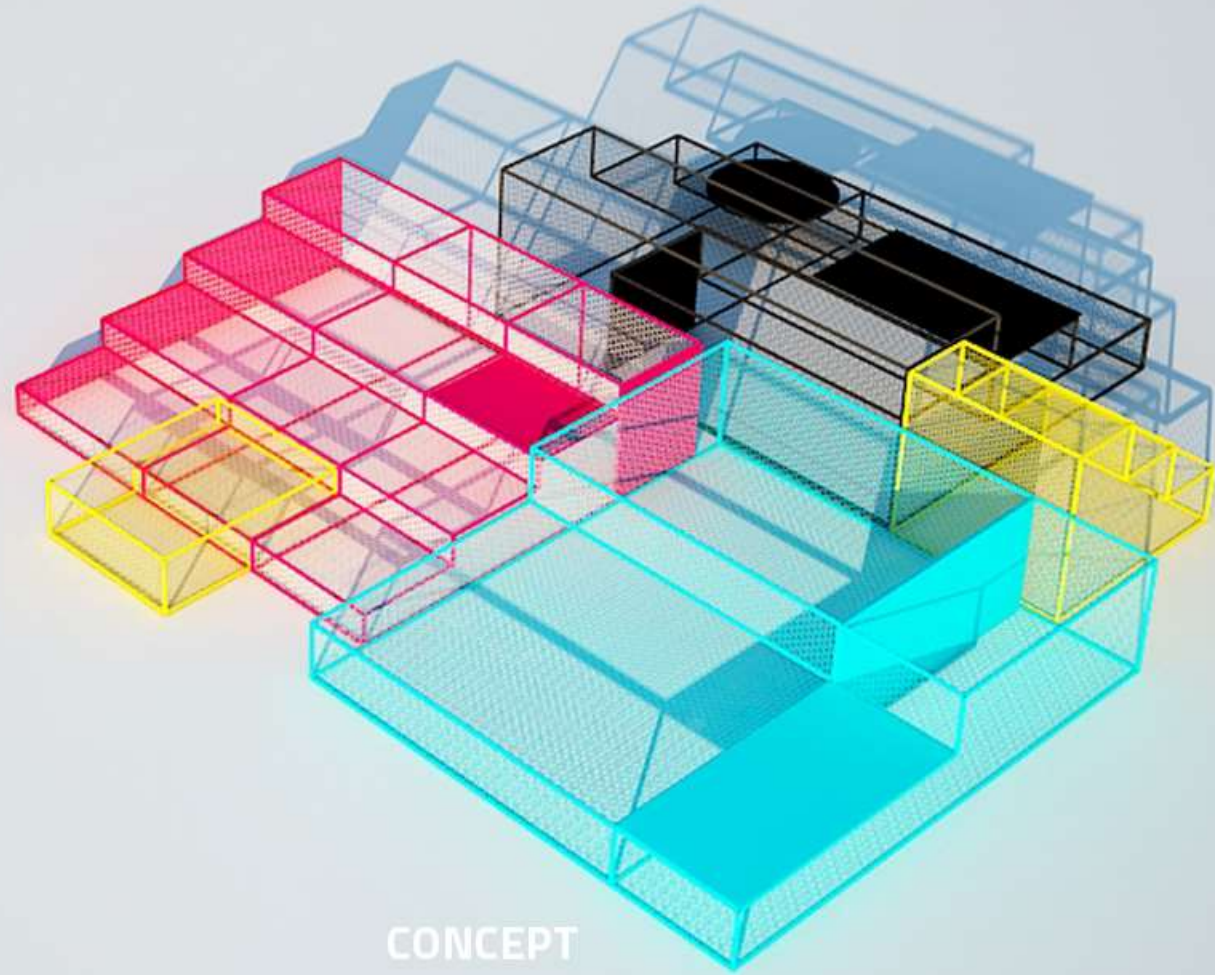

CLIENT

Self initiated project.

GOAL

- Designing an outdoor furniture series for a metal manufacturer company by using a construction material in a different context.

CONCEPT

- Mesh is a family of wireframe structures. The concept includes versions with pots and tables. The design language is shaped around stairs which bring a street feel to the furniture, that also provides the user flexible ways of usage.
- The modules are in-between being an architectural structure and furniture piece.
- The semi transparent mesh metal brings the lightness and different color mixes are seen through each other.

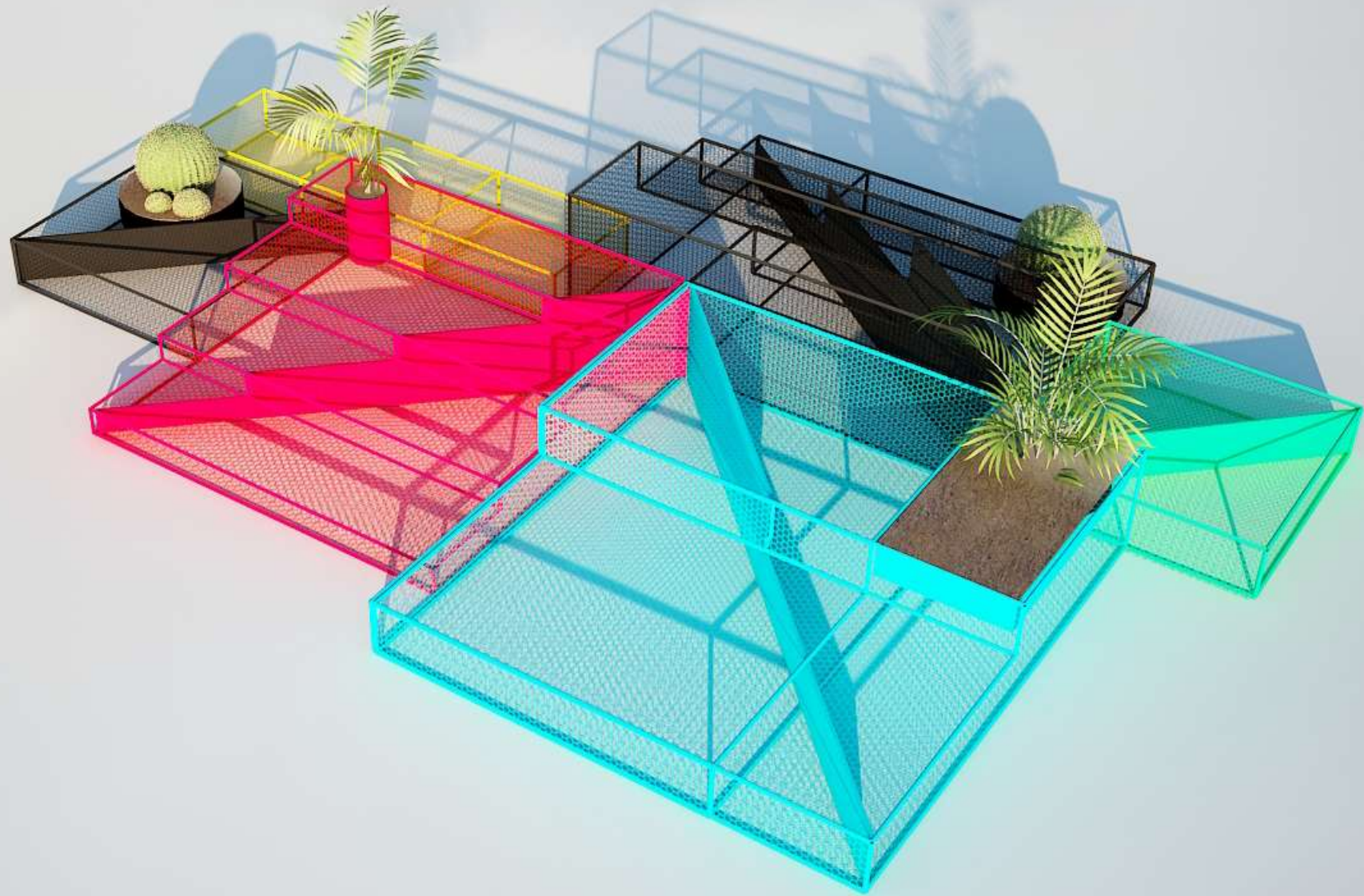

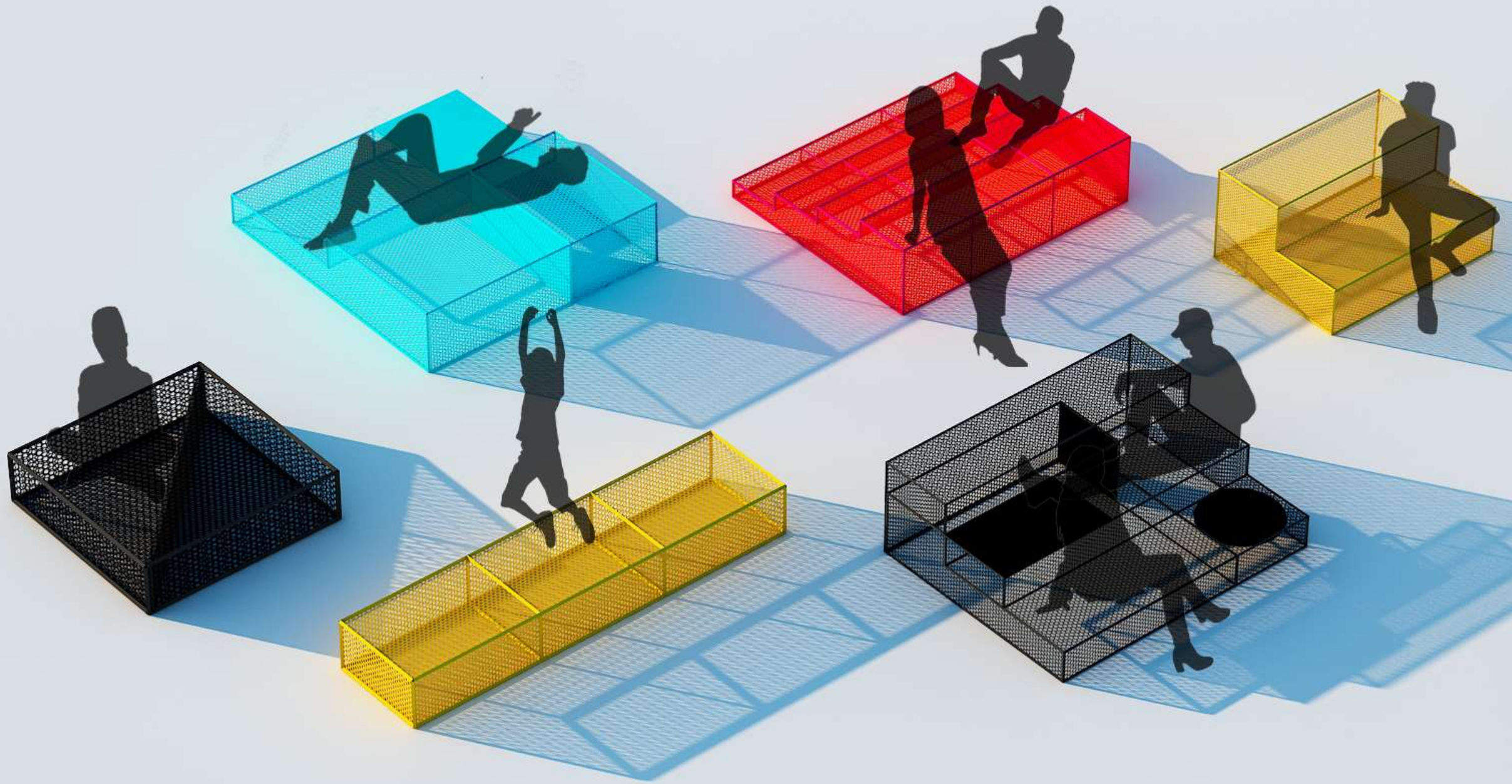

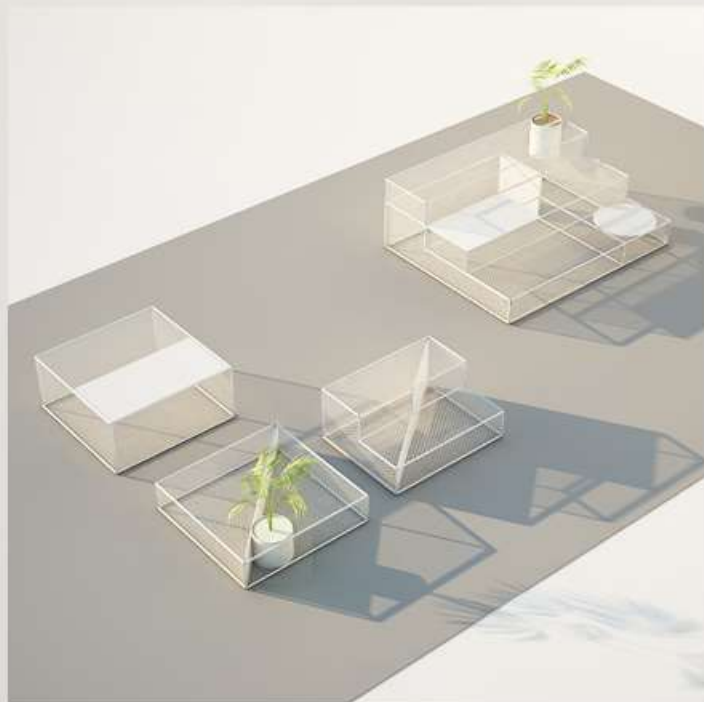

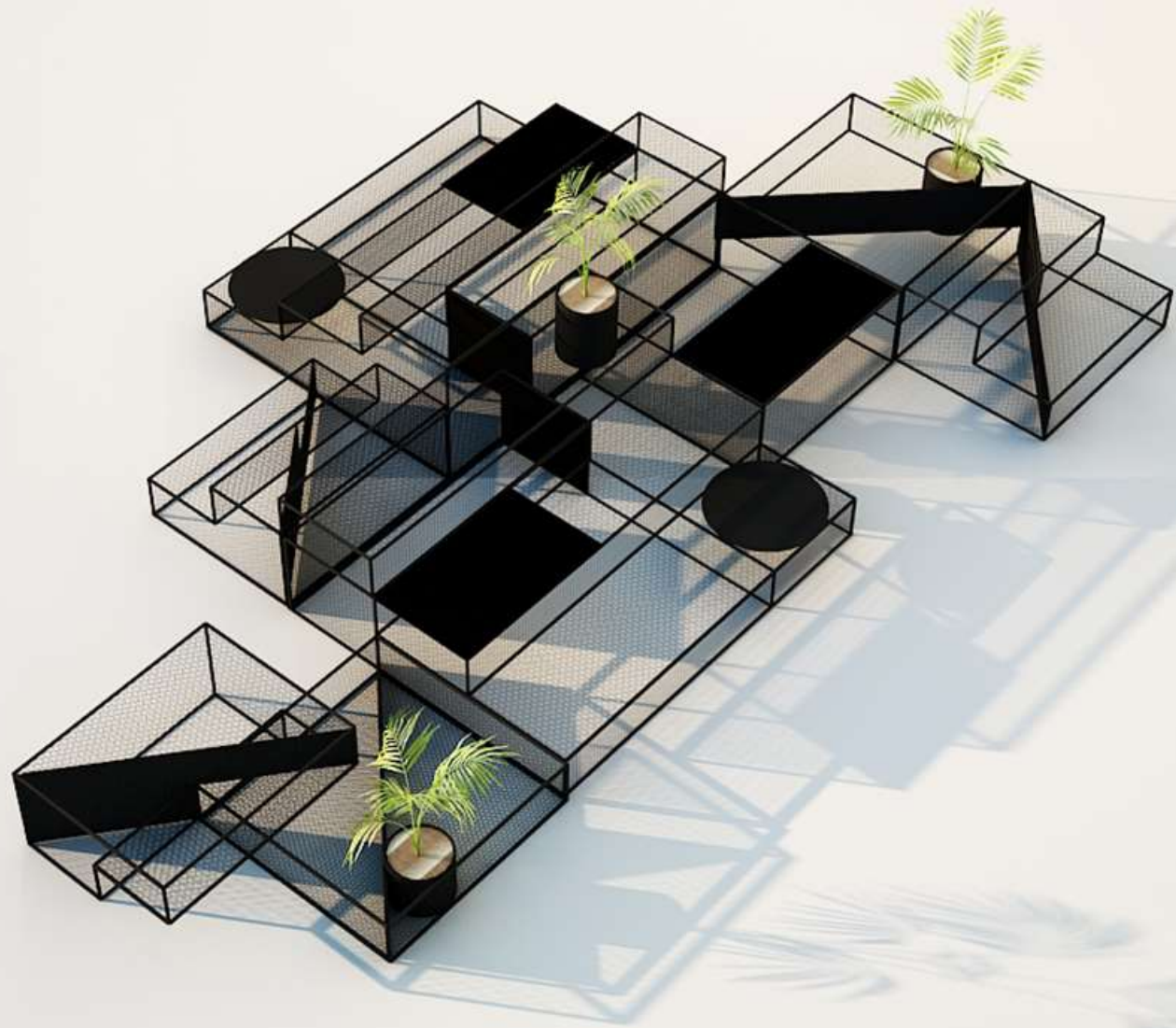



MICROSOFT

Summit Spatial Design

Microsoft Zirve 2007

teknoloji zirve yapıyor

Microsoft
yeni bilginin
kaynaklığına
hazır mısınız?

CREDITS

Role: Industrial Designer

Executed together with demirendesign team as a full-time employee. All intellectual property rights are owned by demirdendesign. No claims are made on sole ownership of this material.

www.demirden.com

INFO

- Project: Microsoft
- Year: 2007
- Location: Istanbul
- Scope: Event Design, Graphic Design



Nobis

open office furniture system



CLIENT



Office and Home Furniture Brand
www.ersamobilya.com

GOAL

- Open office environments have different needs that requires to be supported simultaneously. The goal is to create a lounge system which allows multiple activities like meetings and gatherings.

CONCEPT

- The modular design aims to address different activities, from temporary gatherings to focused meetings, as well as individual partitions.
- That is a system where mobile and stationary units are all integrated to each other for a much more flexible experience.

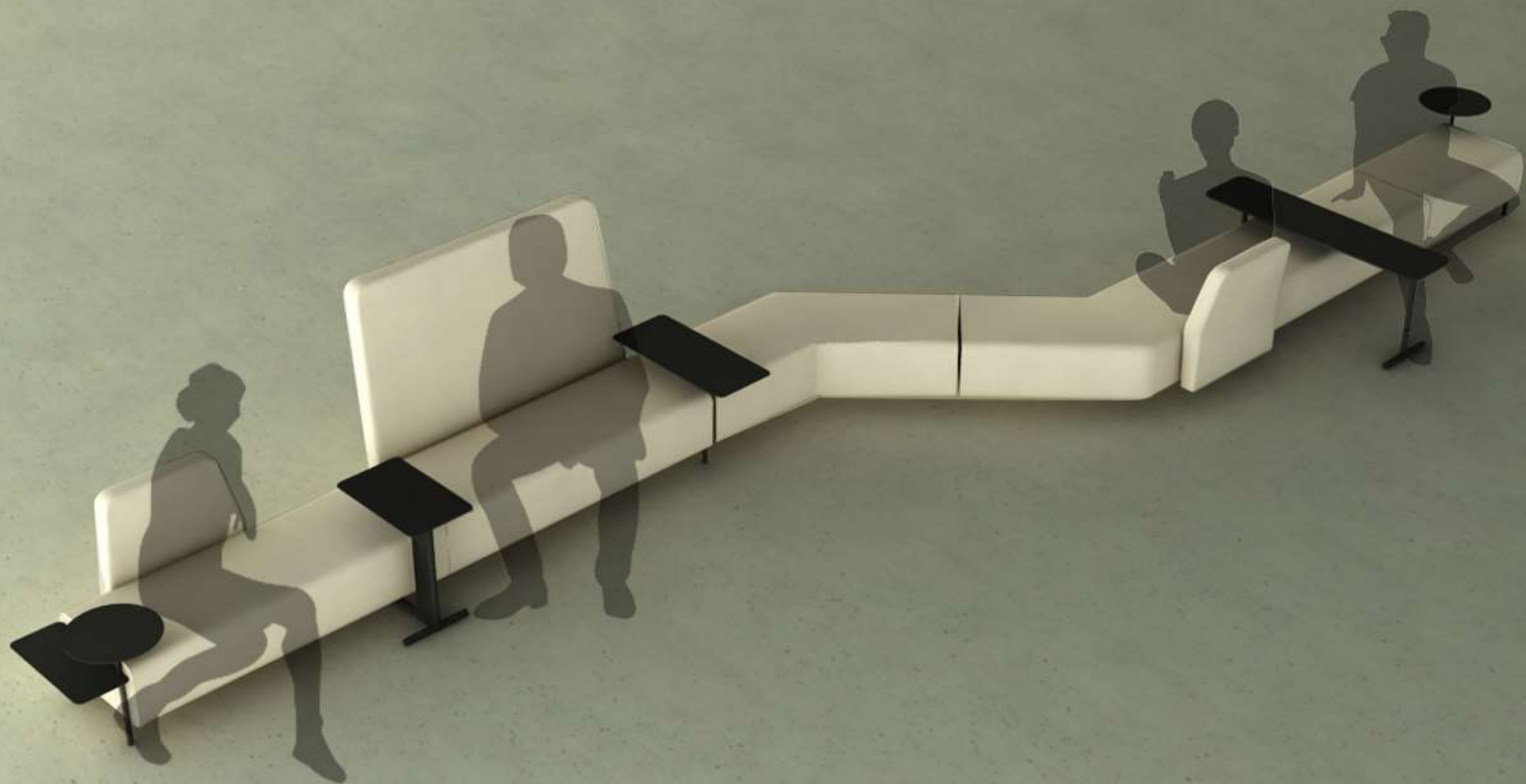





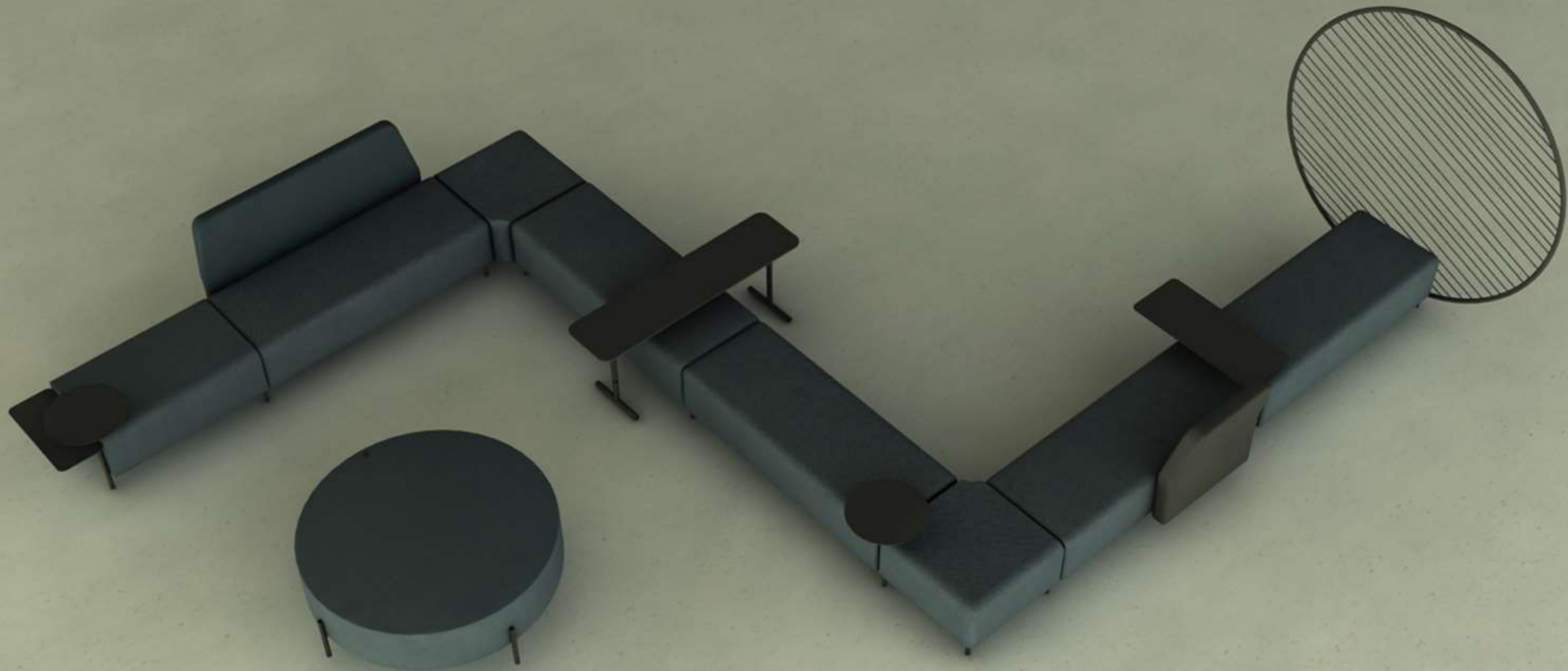



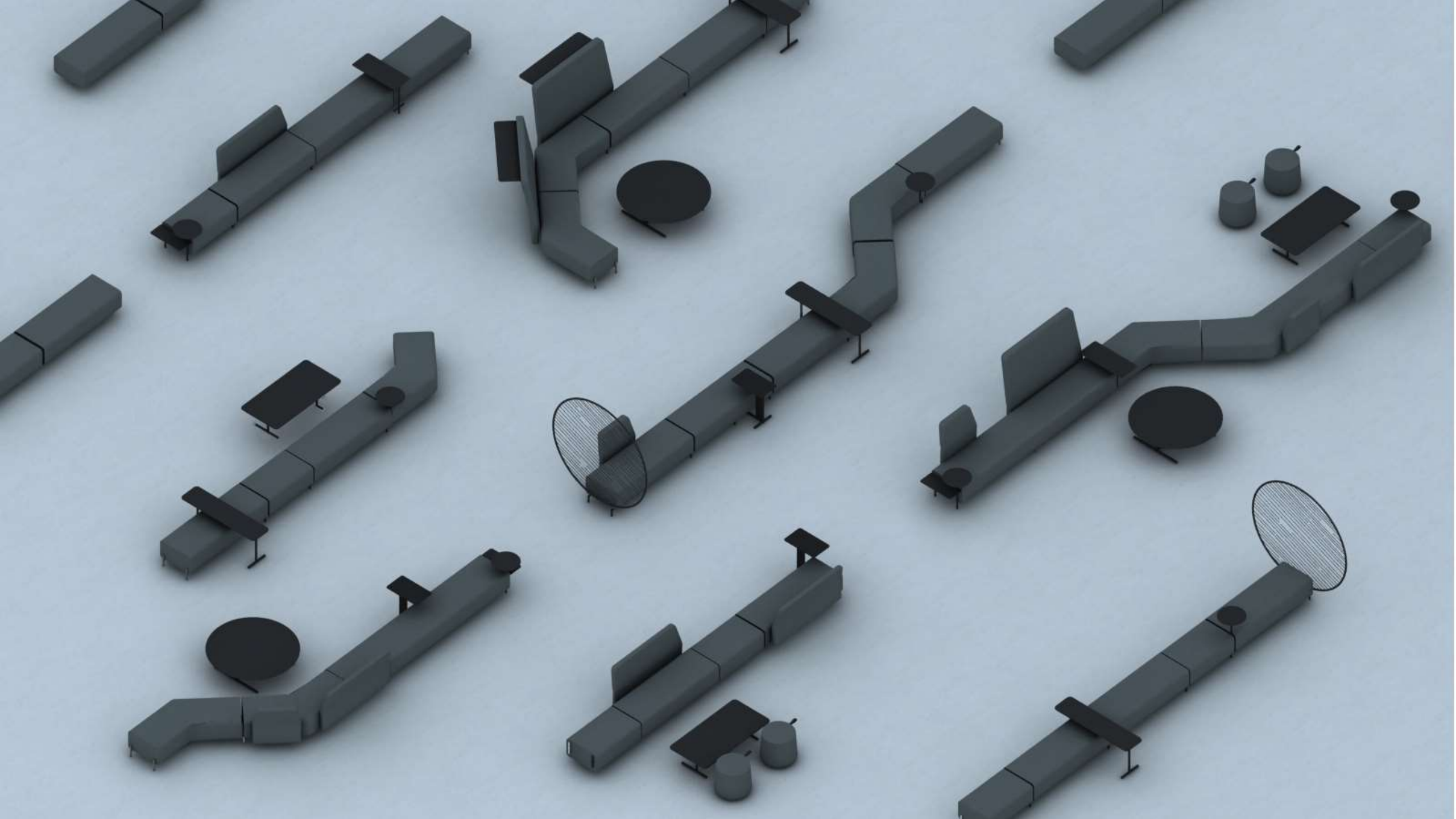

SOFIST

sofa

CLIENT

Self initiated project

Manufactured by local metalworking masters.

GOAL

- Sofist is a part of a collection of products which were selfinitiated to participate Istanbul Design Week Exhibition.
- All manufacturing had been made by local crafts people.

CONCEPT

- Can we use the volume of the sofa as a space for more function?
- The inner volume can be used as a bed for pets, the wireframe houses a magazine rack and sidetable.
- Outdoor usage is available.





SOGMATAR

social responsibility project

CLIENT

atlas

www.atlasharran.com

GOAL

- Atlas is based on a social responsibility model supporting the local and Syrian women living in Harran to generate their economic independence by being at the core of the production process at the felt, wood, weaving and ceramic ateliers developed at ADEM (Family Support Centre) within the Governorship of Harran, Turkey. atlas aims to integrate the social awareness and sustainable design economy with the rising values of the global design scene. Thus the collection is translating Mesopotamian cultural heritage and aesthetics to our times.

CONCEPT

- Sogmatar is inspired by the multi-layered structure of Harran created by various civilizations settled in the area. Every layer is presented in a different material or color of her office organizer which offers a flexible and playful way of organizing office tables.





 **BIGSEE
PRODUCTDESIGN
AWARD 2020
WINNER**

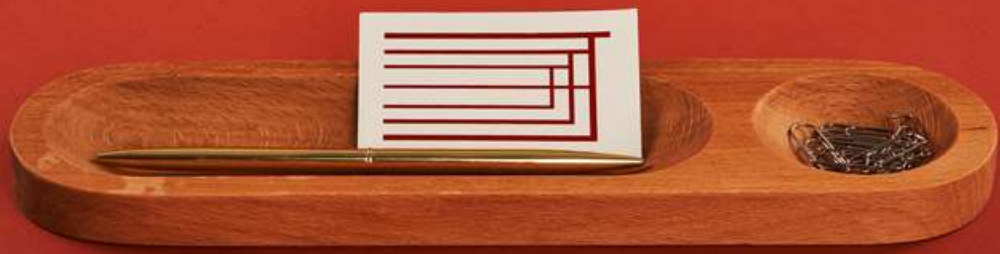



Syrian refugee woman sandpapering the products.



SOGMATAR, Temple of Seven Planets
The worshipping centre of the Planet Cult



Syrian refugee woman working on lathe
Lathe has a low learning curve which makes it easy for participants to learn fast and produce more products in short time.



Wood workshop
%50 of the project income goes to the women in these workshops.

TURKCELL

CEBIT Fair Exhibition Design

CREDITS

Role: Industrial Designer

Executed together with demirendesign team as a full-time employee. All intellectual property rights are owned by demirdesign. No claims are made on sole ownership of this material.

www.demirden.com

GOAL

- Project: Turkcell CeBIT
- Year: 2007
- Location: İstanbul
- Space: 1505 m²
- Scope: Exhibition Design, Graphic Design

CONCEPT

- The motto of Turkey's leading GSM Operator "Connect to Life" is shown with zones that are connected to each other. Each showcasing a service.





TURKCELL

turkcell-im

Tatilde de rahatlıkla bağlan sevdiklerinize



matça bağlan sevdiklerine

TURKCELL

Mobilizasyon

(i)TCELL

Futbol ve Basketbol
Millî Takımları Ana Sponsoru

TURKCELL

SAMSUNG mobile

SIP

TURKCELL



7/A
SALON
HALL 1-2-3-4-5-6K
Emergency Exit

TURKCELL

TURKCELL

TURKCELL

iyi ki varsın
TURKCELL
FUTBOL

12 Takımın Ana Sponsoru

iyi ki varsın
Turkcell SuperLig!
iyi ki
VARSIN
FUTBOL

TURKCELL

Exhibition Design

CREDITS

Role: Industrial Designer

Executed together with demirendesign team as a full-time employee. All intellectual property rights are owned by demirdendesign. No claims are made on sole ownership of this material.

www.demirden.com

INFO

Proje: Turkcell CeBIT

Yil: 2008

Yer: İstanbul

Alan: 1600 m²

Kapsam: Exhibition Design, Graphic Design







FLED

Flush Lighting

CLIENT



KNX Building Solutions Company

www.eaetechnology.com

GOAL

- Redesigning a flush lighting fixture which uses a new diffuser material and making the fixture more preferable for the users.

CONCEPT

- F-LED lighting unit, designed for EAE Lighting Company, the light is taken as a building element. It provides the user the possibility to play with the artificial light and its shadow on the flat ceiling surface. While light is diffused homogeneously through the surface, the user benefits from the alternative bodies of the fixture to deliver the light from the desired direction..



Su

sofa



CLIENT

Birim Mobilya.

BİRİM

www.birim.com

GOAL

- Designing an exclusive sofa for large indoors such as galleries, libraries.

CONCEPT

- Su is a modular sofa that becomes a landscape where people can gather to make various activities.
- A single module provides a transforming surface where the user can get the supporting angles ranging from sitting straight to lying down.





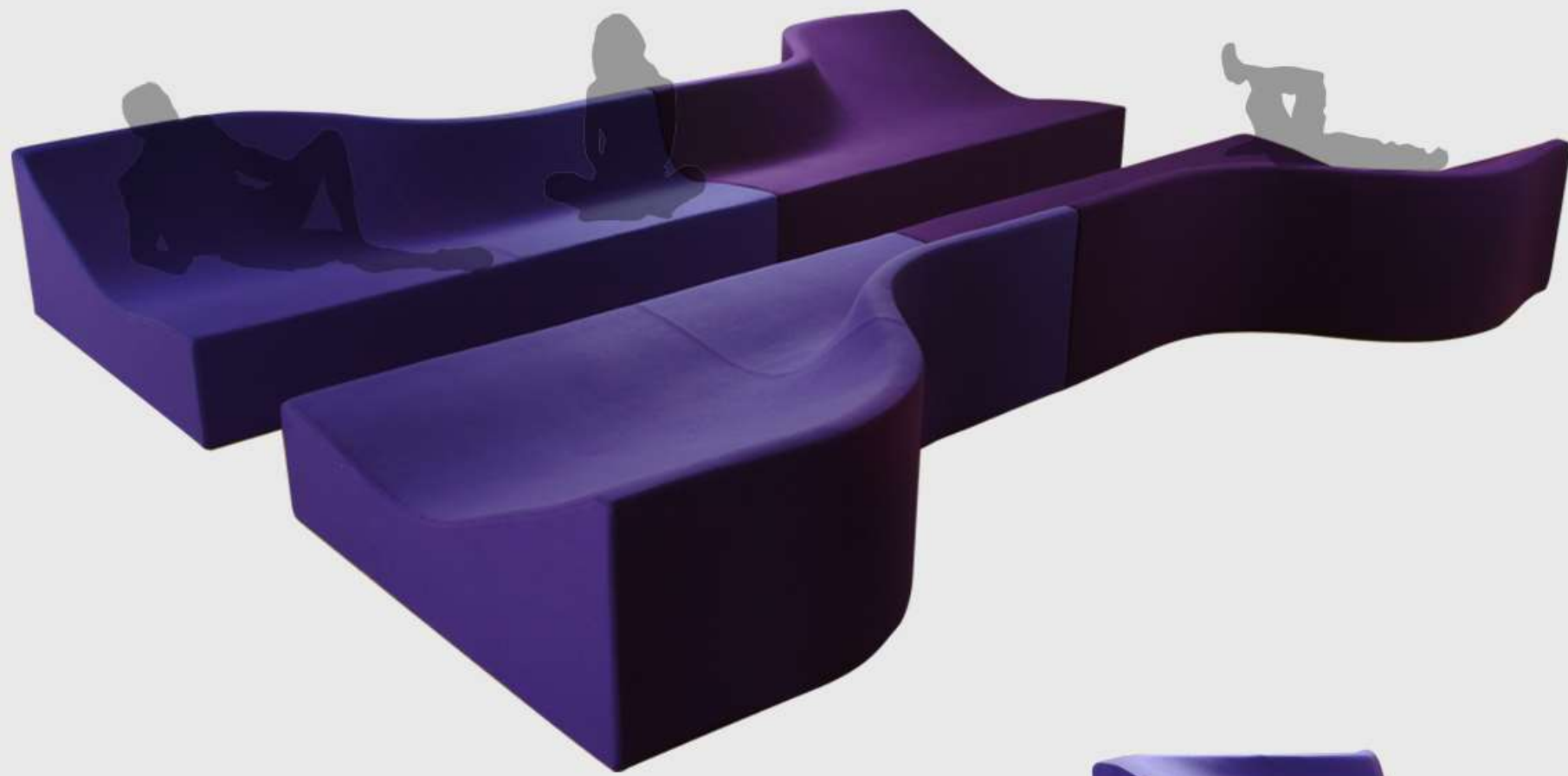

Geo

room divider

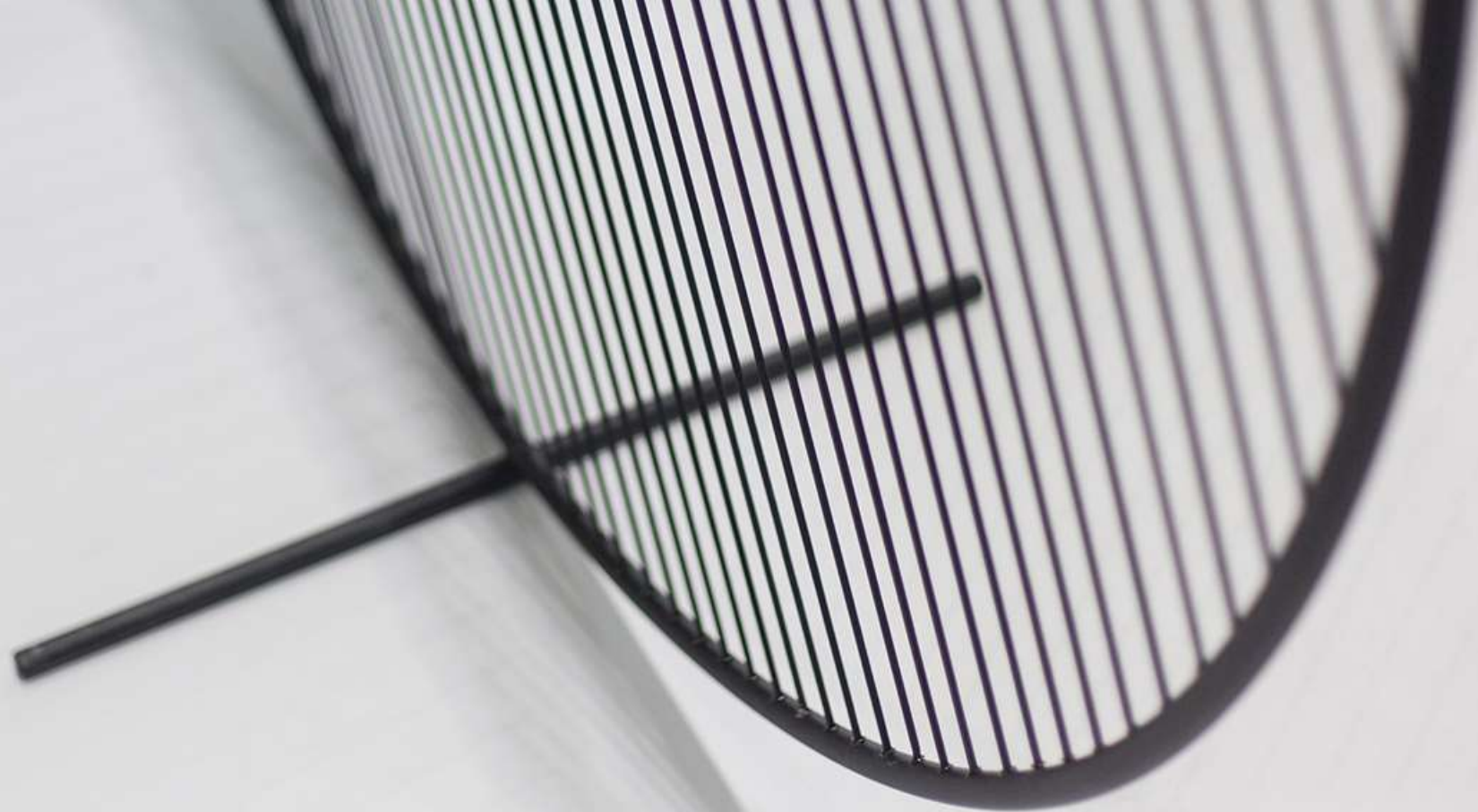

CLIENT



Office & Home Furniture Company.

www.ersamobilya.com

GOAL

- Creating complementary furniture units that can be adopted to contemporary needs of the open office areas.
- Designing a divider that would create intangible partitions.

CONCEPT

- Open office environments encourage interaction between workers, also requiring partitions to define areas for different activities. Geo helps to define these areas without interrupting the interaction.
- The light structure enables to get maximum volume with minimum material.

AR Filter





GERMAN
DESIGN
AWARD
SPECIAL
2016

INTERNATIONAL DESIGN
EXCELLENCE AWARDS '14
FINALIST

GEO

- The plastic clips allows users to play with the elastic strings in order to get different patterns.

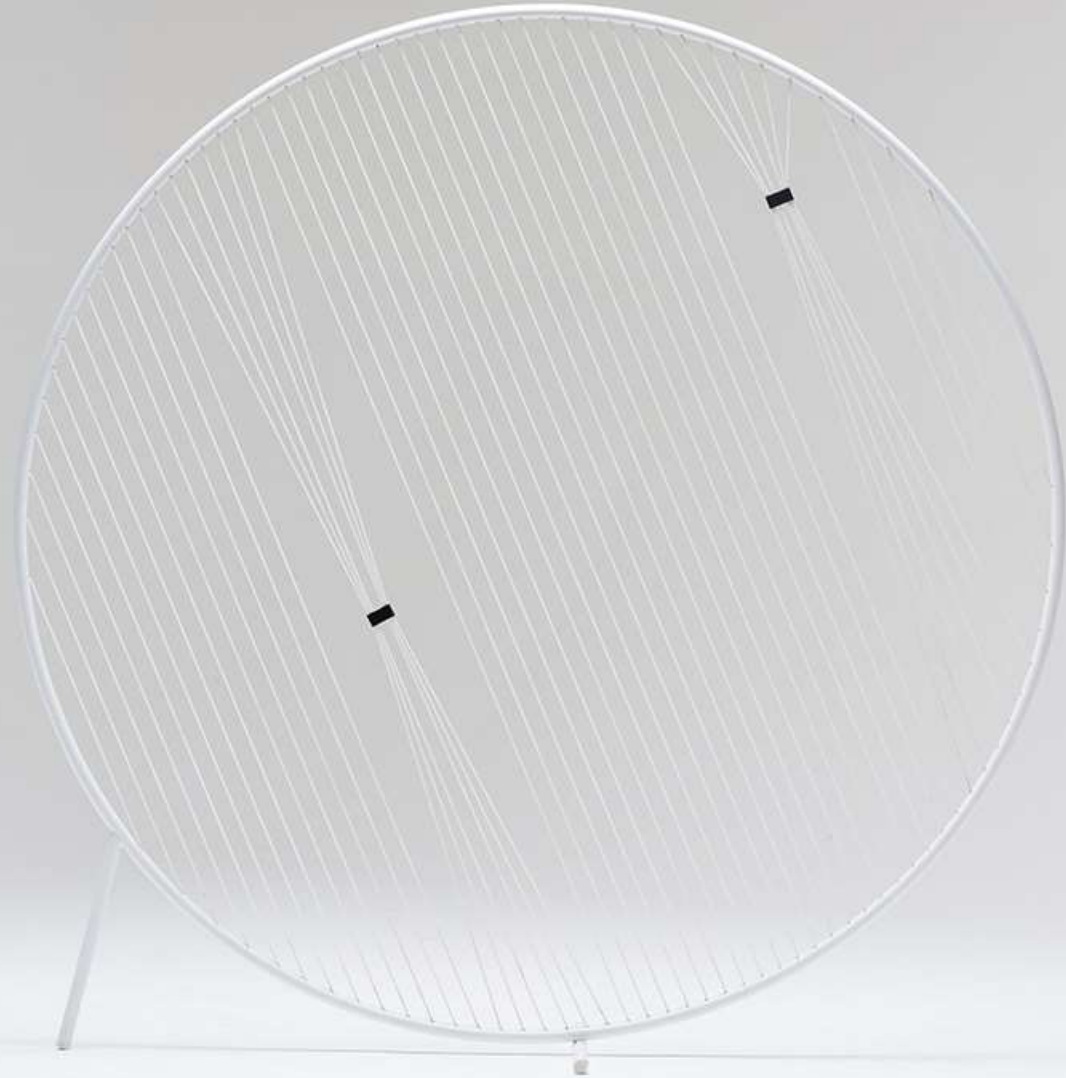

AR Filter





AR Filter





AR Filter



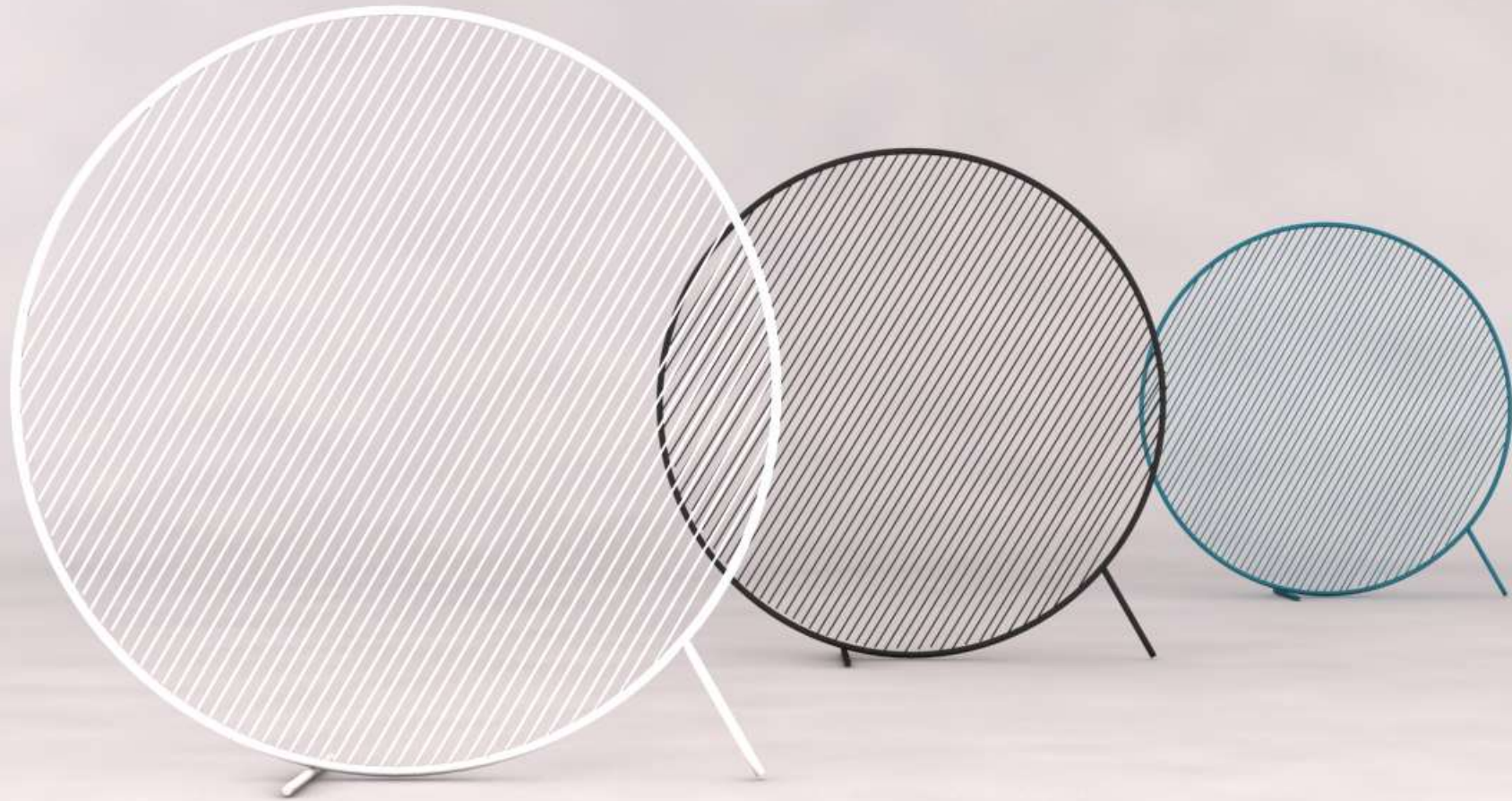

AR Filter



thank you!

looking forward to discuss further..

www.sulekoc.com
info@sulekoc.com
+90 (532) 424 68 00